

SERENE DIFFUSER



HOW TO REFILL *SERENE* DIFFUSER

NOTE: USE FRAGRANCE OIL ONLY – DO NOT ADD WATER.



No keys needed—the machine opens easily with a magnetic pull.



Carefully pour the Rezaroma fragrance oil into the diffuser bottle, **filling it to approximately 80% capacity. Leave a 20% gap at the top to prevent any bubbling sounds during operation.**



Securely screw the cap back onto the diffuser. Turn on your diffuser and indulge in the captivating aroma.



Make sure to plug in the diffuser, then press the 'Fan' button and the power button to turn it on.

SCAN TO DOWNLOAD APPLICATION



SMART AROMA



IOS



ANDROID

HOW THE DIFFUSER WORKS?

Download the application

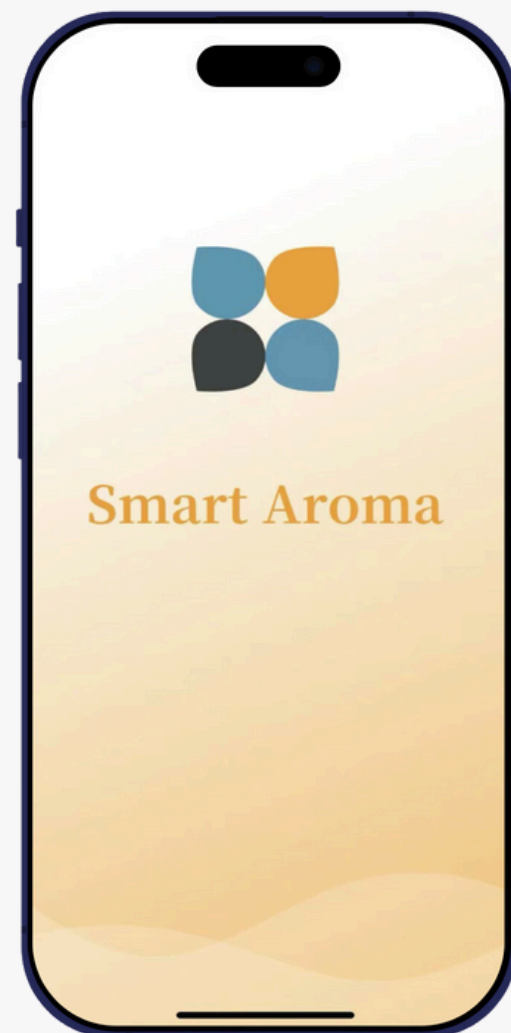

Add the device by clicking +Add

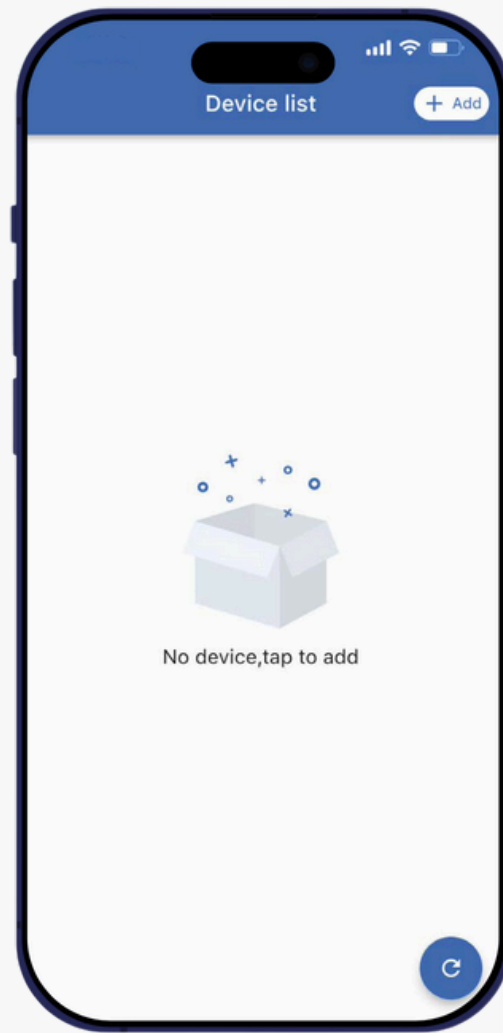

Connect to the device

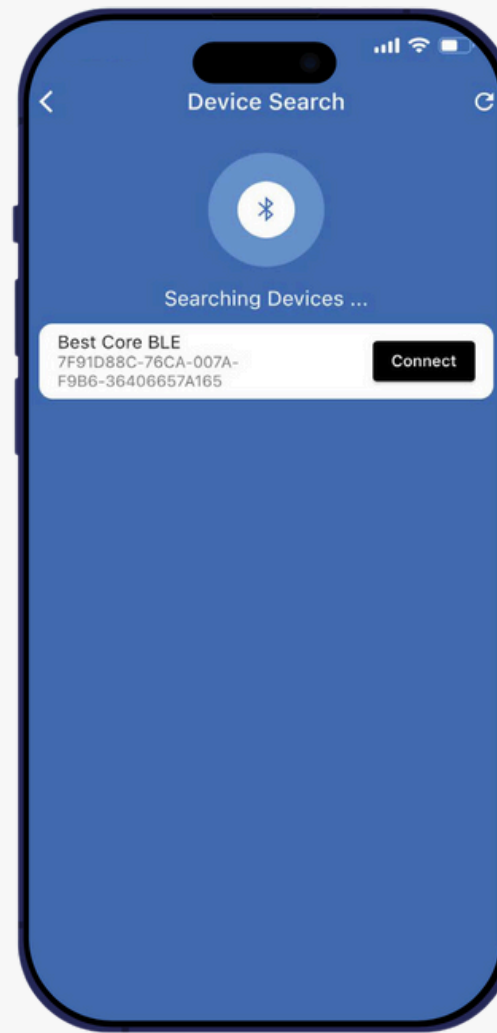

Enter the default password "9999"

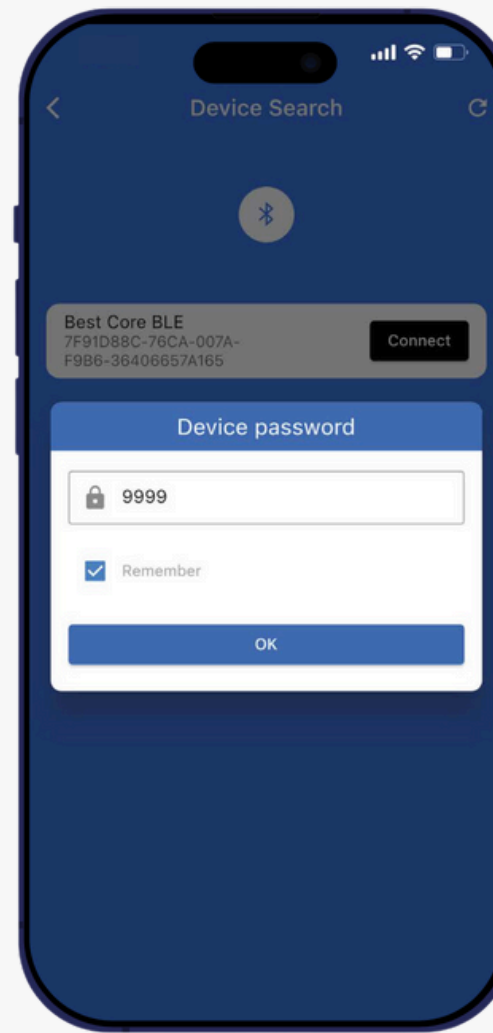

Always put the fan on "HIGH" and press the GROUP 1 to go to the settings page

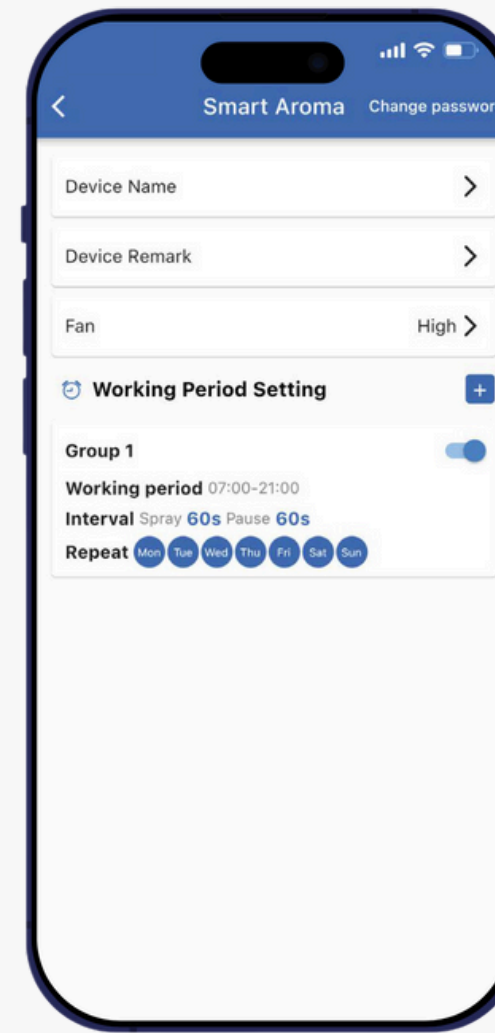

Change the WORK PERIOD and INTERVAL as desired

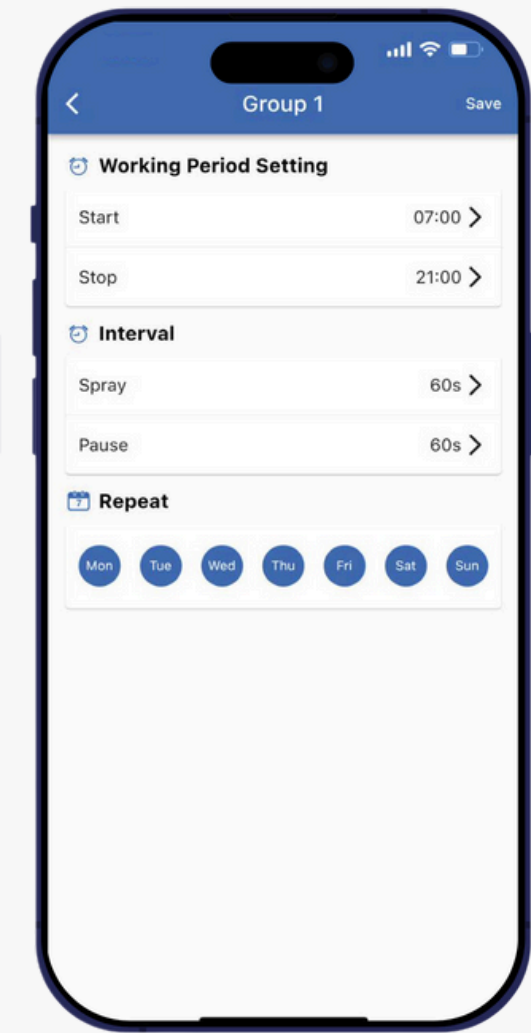

NOTE: STANDARD SETTINGS IS 60S INTERVAL SPRAY AND 60S INTERVAL PAUSE